

School Facilities and Grade Organization Study

Oneida City School District

Advisory Committee

April 27, 2023



Castallo and Silky LLC
Stephen Bocciolatt, Consultant

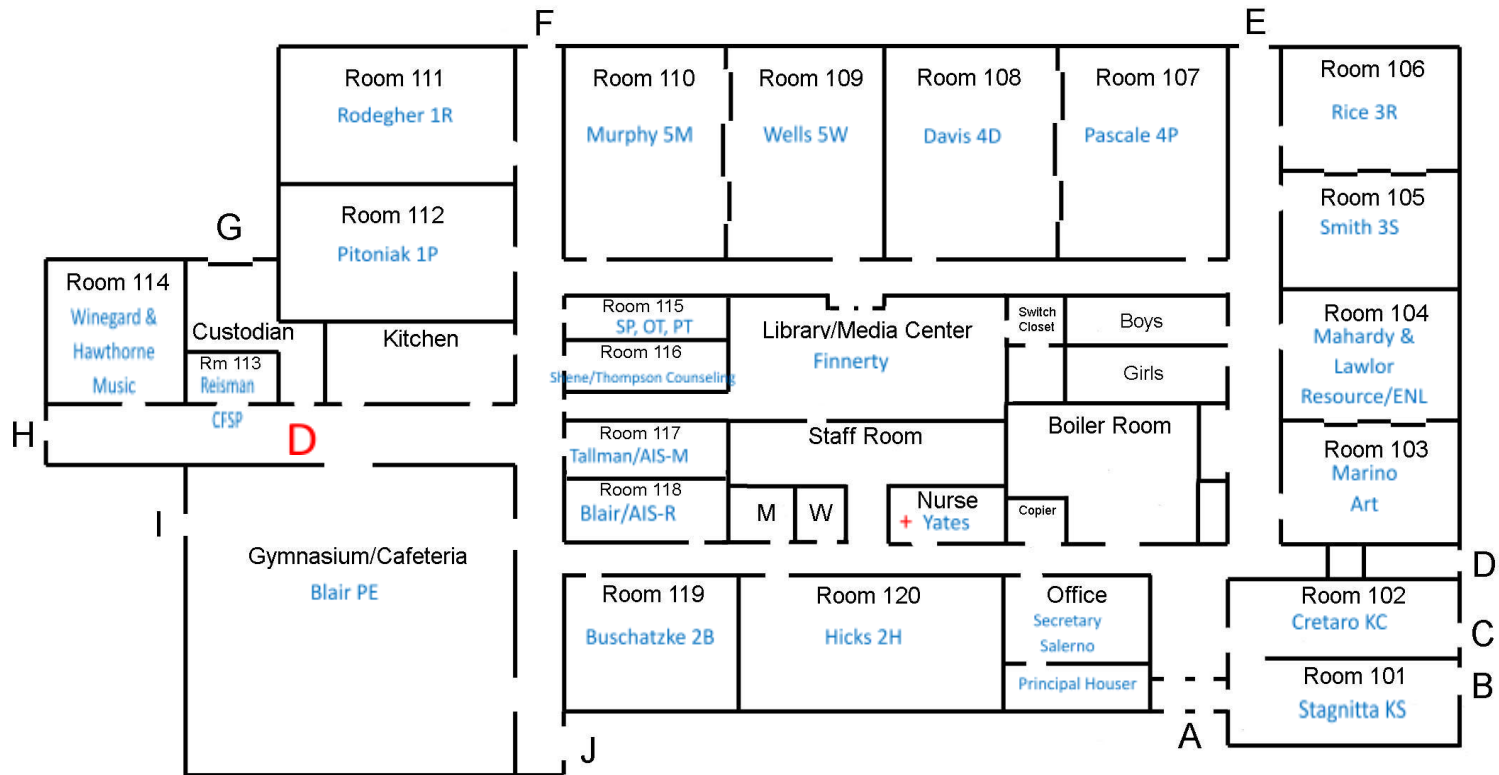

Seneca Street Elementary

2022-2023

D: Emergency Defibrillator
+: First Aid Kit
 Exits: All Letters

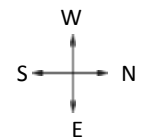

Agenda

- Introduce New Committee Member(s)
- Questions/Comments from Building Tour
- Review Minutes from 3/21/2023 Meeting
 - Review and discuss if any additional advantages and disadvantages should be added to the Pre-K-5 current grade configuration as outlined in the minutes.
- Transportation Overview
- Grade Center Option – Small Group Discussion
- Public Questions/Comments
- Next Meeting Dates/Locations/Topics

Purpose of the Study/Critical Question

”In considering a number of options, is there a better way educationally and fiscally to reconfigure the grades and facilities to provide a sound instructional program now and in the future”?



Take Aways Meeting #1

- The purpose of the study is to answer the question, “In considering a number of options, is there a better way educationally and fiscally to reconfigure the grades and facilities to provide a sound instructional program now and in the future”?
- The study process will be open to ensure there is not a perception it is being conducted behind closed doors.
- The Advisory Committee was formed to assist the consultant throughout the process, but the final recommendation(s) will be the consultant’s.
- The district has seen declining enrollments and will likely continue to see enrollments drop.

TAKEAWAYS

Take Aways Meeting #2

- Building Tour of Durhamville: Main questions/comments
 - It is not unusual to share spaces for support services. Shared spaces for OT/PT/Speech and Music/Art did not seem to be ideal. Some support services did have reasonable size rooms/areas.
 - Separate gym and cafeteria was noted. Not all elementary schools have both areas.
 - Special Education classrooms are at DV and WP. Resource rooms are at all 4 elementary buildings.
 - Storage space is an issue.
- The 2020 Building Condition Survey(BCS) for all buildings in the district identified approximately \$15,800,000 of work to be completed in the district's facilities. This information will be updated to take into account the work being completed in the 2021 capital improvement project.

TAKEAWAYS

Take Aways Meeting #2

- Educational Space Utilization: Questions/comments were reviewed for all four elementary buildings.
 - Highlighted special education classrooms at both DV and WP.
 - It was stated WP was built for early elementary classrooms and special education services. There are large bathrooms in many classrooms throughout the building.
 - It was noted DV has room/land to build an addition.
- Two common approaches to organizing elementary attendance zones.
 - Neighborhood Concept
 - Grade Center Concept (Princeton Plan)

Take Aways Meeting #3

- The neighborhood school concept has been embraced by Oneida for the location of its elementary schools.
- The current elementary school class sizes are well below guidelines set by policy, general procedures, and the teacher contract.
- The most common grade configuration of schools in New York and the U.S. is K-5, 6-8, 9 -12, although there does not seem to be any consistent research that indicates that one grade pattern is necessarily better for student learning than another.
- The elementary special subject area program is comparable across all four schools.

TAKEAWAYS

Take Aways Meeting #3

- Building Tour of Willard Prior: Main questions/comments
 - Very few shared spaces for support services.
 - Separate gym and cafeteria was noted.
Not all elementary schools have both areas.
 - Special Education classrooms are at DV and WP.
Resource rooms are at all 4 elementary buildings.
 - One story
 - Bathrooms in classrooms
 - St. Patrick's services are provided by WP staff
 - UCP space rental
 - District Pre-K students housed at WP
- Advantages and Disadvantages of current Pre-K-5 grade configuration were discussed in four break-out groups.
Common threads will be noted at the next committee meeting

TAKEAWAYS

Question/Follow Up From Previous Meetings



www.shutterstock.com - 553127521

In-Zone & Out-of-Zone

Students attending each elementary building from their elementary attendance zone (In-Zone) and from other elementary buildings attendance zones (Out-of-Zone)

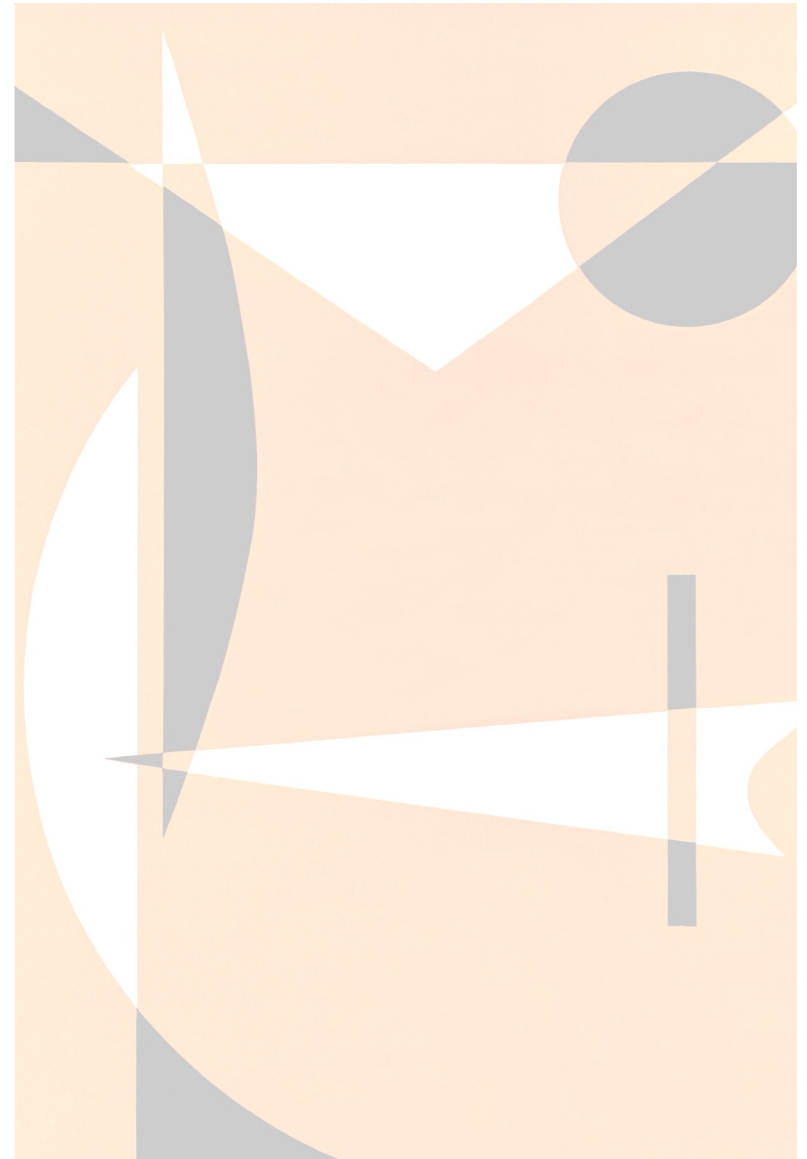

Durhamville Elementary

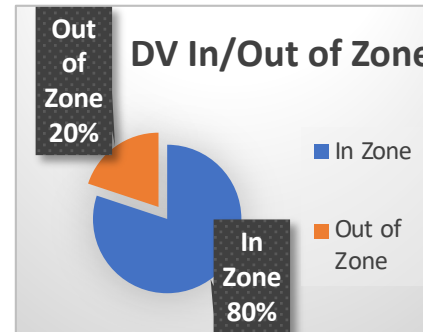
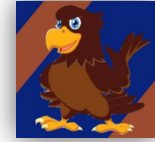

Durhamville	
In Zone	177
Out of Zone	44
Total	221
DV out of zone reasons	
CSE Placed	26
Special Permission	15
Home building capped	2
Homeless	1
ESL/ENL	0
Total	44

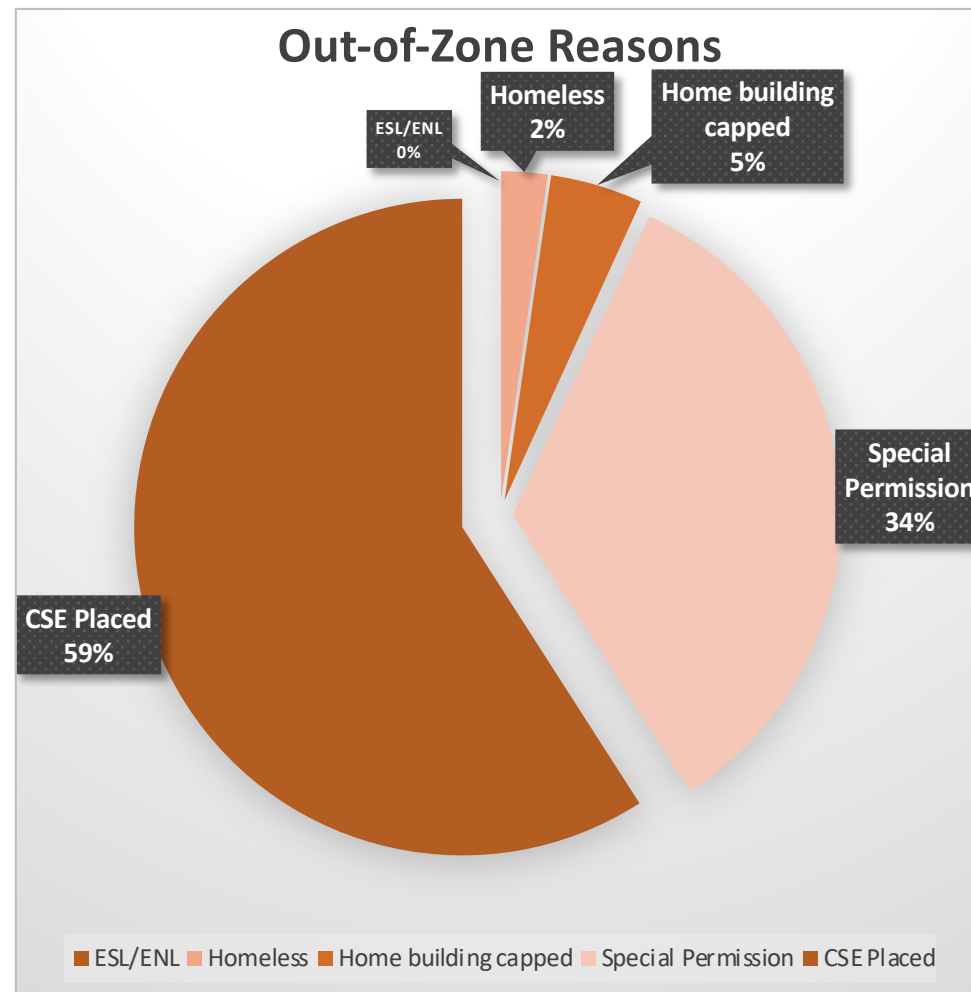

Durhamville Elementary

Number of Out of Zone Students Attending Durhamville from each elementary building

Durhamville	
In Zone	177
Out of Zone	44
Total	221

DV out of zone reasons	
CSE Placed	26
Special Permission	15
Home building capped	2
Homeless	1
ESL/ENL	0
Total	44

DV OUT OF ZONE 44						
Coming from zone	CSE	ENL	Home building capped	Homeless status	Special permission (Sibling, Change of address during the year, any other reason)	Total
NB	12	0	1	0	10	23
SS	4	0	0	0	3	7
WP	10	0	1	0	2	13
Out of district (Homeless status)	0	0	0	1	0	1
Total	26	0	2	1	15	44

North Broad Elementary

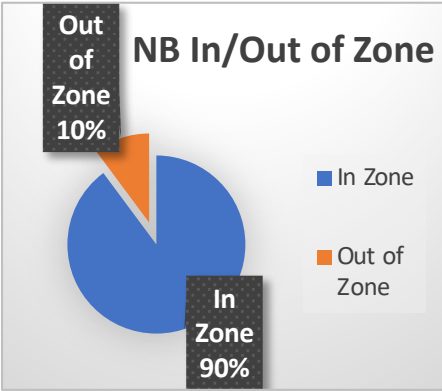

North Broad	
In Zone	160
Out of Zone	18
Total	178

North Broad Out of Zone reasons	
CSE Placed	0
Home building capped	2
ESL/ENL	0
Homeless	2
Special Permission	14
Total	18

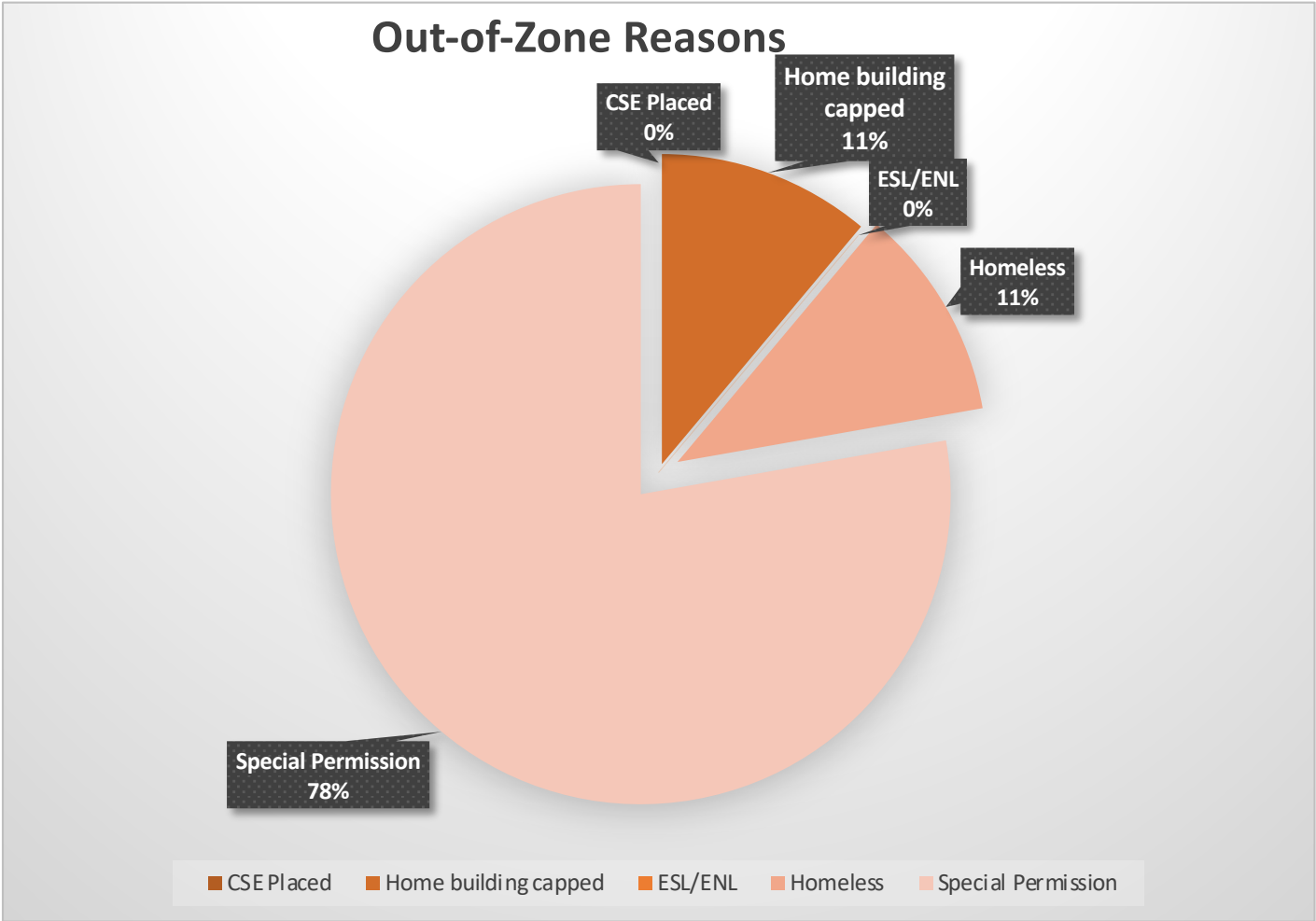

North Broad Elementary

Number of Out of Zone Students Attending North Broad from each elementary building

North Broad	
In Zone	160
Out of Zone	18
Total	178

North Broad Out of Zone reasons	
CSE Placed	0
Home building capped	3
ESL/ENL	0
Homeless	2
Special Permission	13
Total	18

NB OUT OF ZONE 18						
Coming from zone	CSE	ENL	Home building capped	Homeless status	Special permission (Sibling, Change of address during the year, any other reason)	Total
DV	0	0	0	0	3	3
SS	0	0	0	0	7	7
WP	0	0	2	0	4	6
Out of district (Homeless status)	0	0	0	2	0	2
Total	0	0	2	2	14	18

Seneca Street Elementary



Seneca Street	
In Zone	163
Out of Zone	43
Total	206

Seneca Street Out of Zone reasons	
CSE Placed	0
Home building capped	13
ESL/ENL	8
Homeless	1
Special Permission	21
Total	43

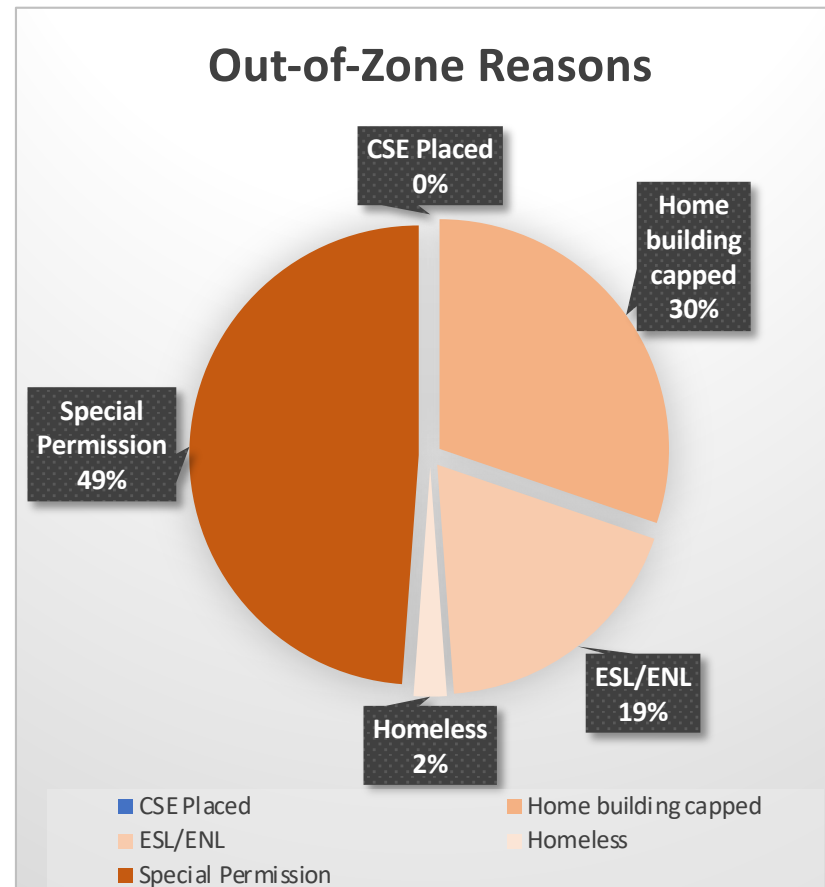
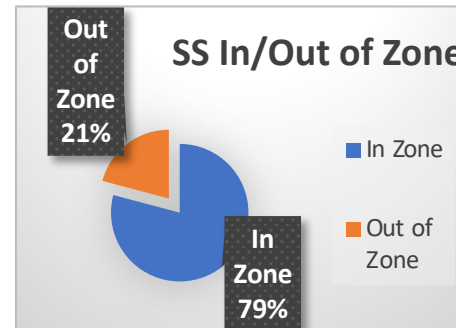

Seneca Street Elementary

Number of Out of Zone Students Attending Seneca Street from each elementary building

Seneca Street	
In Zone	163
Out of Zone	43
Total	206

Seneca Street Out of Zone reasons	
CSE Placed	0
Home building capped	13
ESL/ENL	8
Homeless	1
Special Permission	21
Total	43

SS OUT OF ZONE 43						
Coming from zone	CSE	ENL	Home building capped	Homeless status	Special permission (Sibling, Change of address during the year, any other reason)	Total
DV	0	4	1	0	4	9
NB	0	3	7	0	5	15
WP	0	1	5	0	12	18
Out of district (Homeless status)	0	0	0	1	0	1
Total	0	8	13	1	21	43

Willard Prior Elementary



K-5	141
Pre-K	84
WP Total number of students	225

WP total number of students

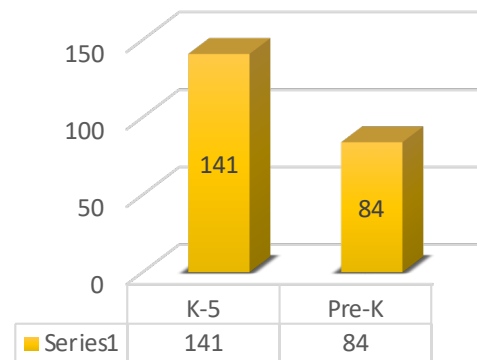

Willard Prior Elementary

Willard Prior	
In Zone	92
Out of Zone	49
Total (K-5)	141

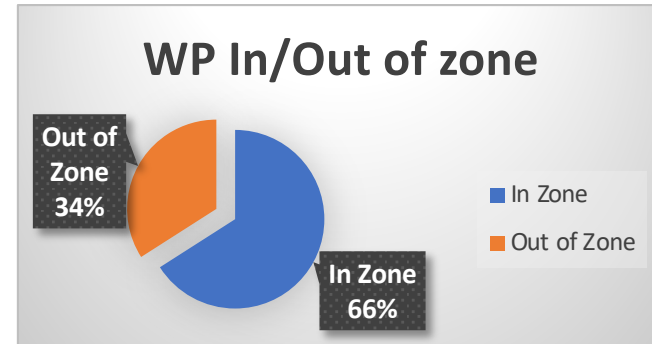

WP Out of Zone reasons	
CSE Placed	27
Home building capped	4
ESL/ENL	0
Homeless	2
Special Permission	15
Total	48

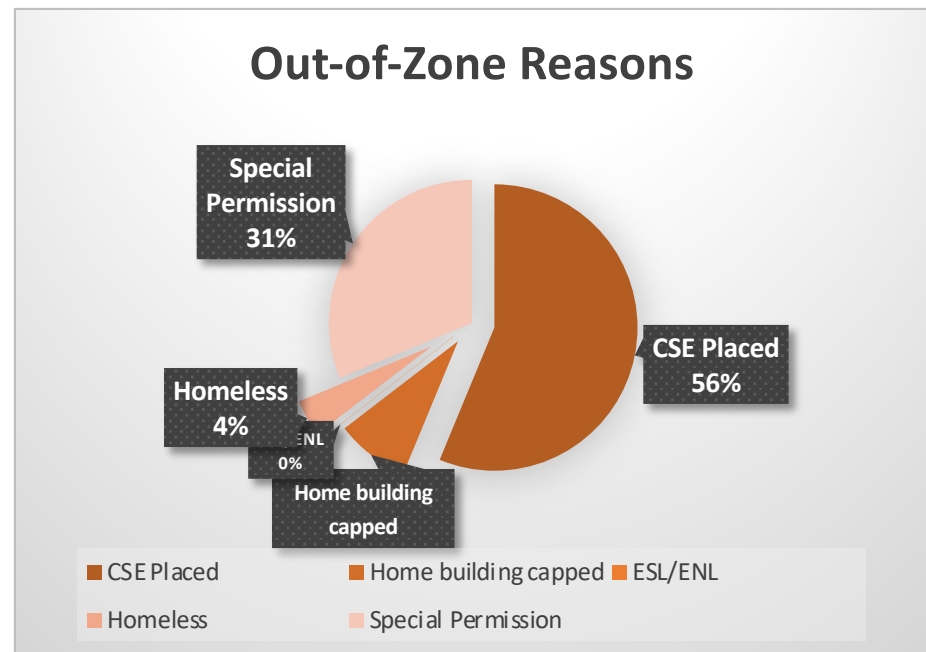

Willard Prior Elementary

Number of Out of Zone Students Attending Willard Prior from each elementary building

Willard Prior	
In Zone	92
Out of Zone	49
Total (K-5)	141

WP Out of Zone reason	
CSE Placed	27
Home building capped	4
ESL/ENL	0
Homeless	2
Special Permission	15
Total	48

WP OUT OF ZONE 48						
Coming from zone	CSE	Home building capped	ENL	Homeless status	Special permission (Sibling, Change of address during the school year, any other reason)	Total
DV	7	0	0	0	1	8
NB	14	4	0	0	11	29
SS	6	0	0	0	4	10
Out of district (Homeless status)	0	0	0	2	0	2
Total	27	4	0	2	15	48

In Zone/Out of Zone Totals

	Total	In Zone	Out of Zone
Willard Prior	141	93	48
Seneca Street	206	163	43
Durhamville	221	177	44
North Broad	178	160	18
Totals	746	593	153

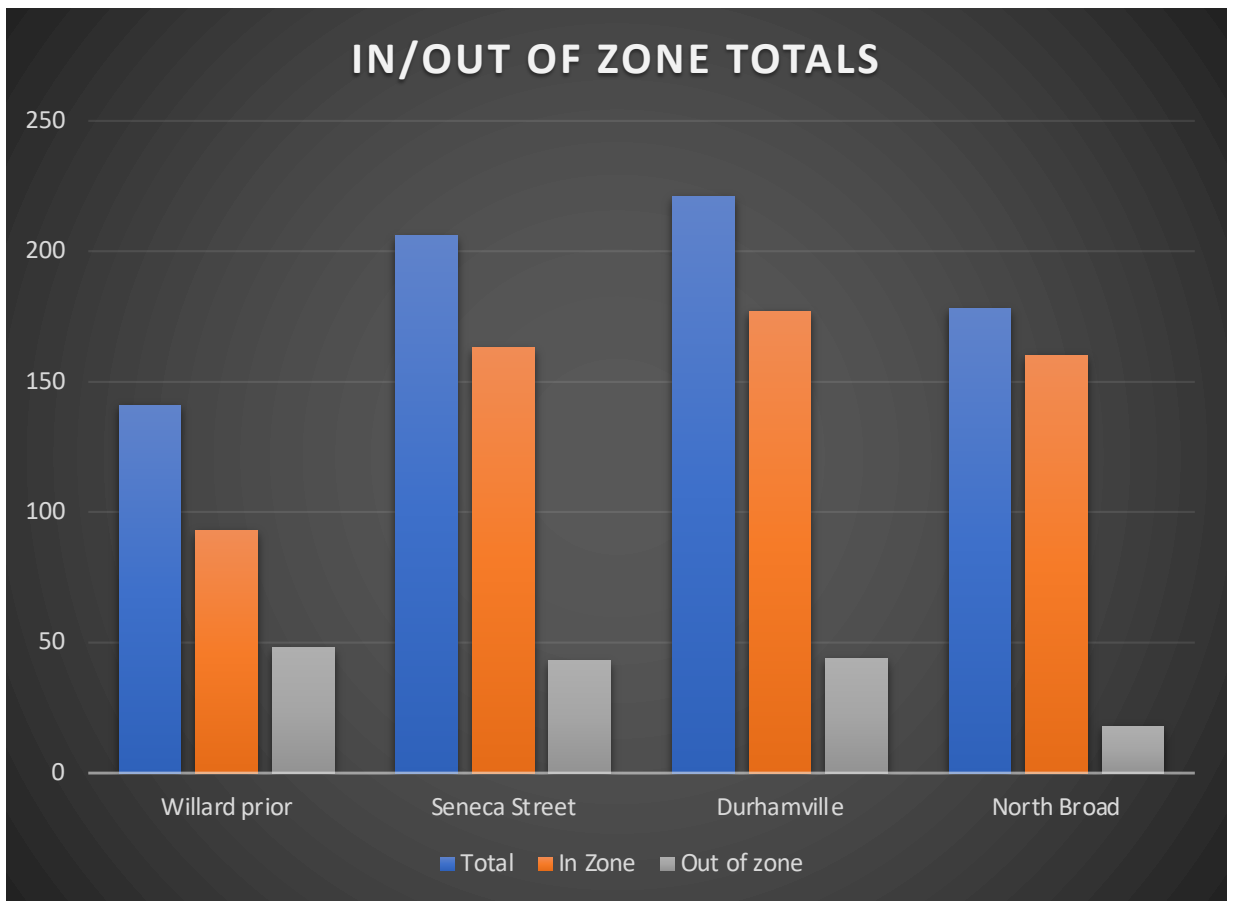

Transportation Overview



Transportation Update

- Cost of a 66-Passenger bus is approximately \$172,800 cost for a bus equipped with a wheelchair lift is approximately \$187,125.
- The district is in the eight year of a nine year transition plan to replace all of its vehicles and finance the bus purchases through a five year lease replacement plan.
- The district has thirty-two 65/66/70 passenger buses, three 53/54/59 passenger buses (all with a wheelchair lift), one 30 passenger bus, one 22 passenger bus with a wheelchair lift used as a spare bus and one 8 passenger suburban bus. Of the thirty-two 65/66/70 passenger buses, five are used as “spare” buses or for special runs.
- Mileage on the vehicles range from 4,396 miles to 20,596 miles and the model years range from 2013 to 2022.



Transportation Policy

Walking Distance: Pick-Up Points

- Grades Pre-K & K will be picked up at home
- Grades 1-5 – walking distance to stop of up to .2 miles
- Grades 6-12 – walking distance to a stop of up to .5 miles
- Pupils with disabilities may be given individual consideration
- Transportation will be provided to students living along a major highways
- Modification to transportation on side roads may be necessary if unsafe conditions exist. Examples of unsafe conditions are flooding, road erosion, mud, snow and ice.

Transportation

Walk Out Zone:

Walking distance to a school building within .5 miles radius of the school building

- Walkers

- ❖ Durhamville: 0
- ❖ North Broad: 12
- ❖ Seneca Street: 7
- ❖ Willard Prior: 5
- ❖ Middle School: **TBD**
- ❖ High School: **TBD**



Transportation

Bus Routes:

A reasonable attempt shall be made to limit the maximum bus route time to one hour.

- Bus Runs: From the first pick-up stop to drop off at school
 - ❖ Longest: **TBD**
 - ❖ Shortest: **TBD**
 - ❖ Average: **45/48 or 60+- minutes**

- Number of Bus Runs
 - ❖ Durhamville: 6
 - ❖ North Broad: 4
 - ❖ Seneca Street: 4
 - ❖ Willard Prior: 5
 - ❖ Middle School: 12
 - ❖ High School: 10

Transporting Students to and from School

- The district uses a double trip system transporting students to and from school
 - First Trip: middle & high school students
 - Second Trip: elementary students
- There are 43 daily bus runs (am & pm)
- There are several separate bus shuttles
 - **In-District** (4 bus runs for special needs transportation)
 - ❖ MS: 1 bus run
 - ❖ HS: 1 bus run
 - ❖ DV/NB: 1 bus run
 - ❖ WP/SS; 1 bus run
 - St. Patrick's (4 bus runs pm only)
 - Holy Cross (1 bus run am & pm)
 - Pre-K (4 bus runs mid-day only)
 - Late buses
 - ❖ MS & HS: 3 bus runs
 - ❖ Elementary: 5 bus runs on Tuesday and Thursday only



Times of Regular Bus Runs

AM	Middle School	6:15/6:30 am to 7:30 am
	High School	6:15/6:30 am to 7:25 am
	Durhamville North Broad Seneca Street Willard Prior	7:30/7:40 am to 8:30/ 8:45 am
PM	Middle School	2:26/2:30 pm to 3:00/3:15 pm
	High School	2:22/2:25 pm to 3:00/3:15 pm
	Durhamville North Broad Seneca Street Willard Prior	3:00/3:15 pm to 4:15/4:30 pm



www.shutterstock.com · 519339

Out of District Bus Runs

Special Education Bus Runs

- VVS
 - MS & HS: 3 bus runs to VVS Middle School (BOCES Program) and Madison Oneida (MO) BOCES Tri-Plex
 - Elementary: 2 bus runs to JD George Elementary (BOCES Program)
- UCP Chadwicks & House of Good Shepard: 1 bus run. Also, 1 student who attends House of Good Shepard also attends Oneida Herkimer (OHM) BOCES in the afternoon.

Special Education, CTE and Alternative Education Bus Runs

- Madison Oneida (OM) BOCES Bus Runs (2 bus runs am, mid-day, and pm)

Castallo & Silky LLC-*Education Consultants*



The District's Elementary Schools are Located Relatively Close Together

Mileage Between Elementary Schools				
	Durhamville	North Broad	Seneca Street	Willard Prior
Durhamville		2.4	3.5	3.1
North Broad	2.4		1.1	.9
Seneca Street	3.5	1.1		.5
Willard Prior	3.1	.9	.5	

Current School/Grade Organization

2022-23 Grade Configuration	
Building	Grade Levels
Durhamville Elementary	K-5
North Broad Elementary	K-5
Seneca Street Elementary	K-5
Willard Prior Elementary	Pre-K-5
Otto Shortell Middle School	6-8
Oneida High school	9-12

Two Common Approaches to Organizing Elementary Attendance Zones

- A. Neighborhood School Concept-Each elementary school contains all elementary grades and is generally organized around “neighborhoods.”
- B. Grade Center Concept (Princeton Plan)-Each elementary school is generally organized around grades, often creating primary schools and intermediate schools within a school district.



2022-2023 Elementary Class Size

Class Sizes – 2022-2023 by Section For Each Elementary School					
Grade	Number of Sections and Class Size of Each Section				
	Durhamville	North Broad	Seneca Street	Willard Prior	Total by Grade
Pre-K	-	-	-	81*	
K	15,16	22	17,18	14	102
1	22,22	20	19,20	20	123
2	17,17	19,20	18,19	19	129
3	15,19	16,17	18,19	22	126
4	17,18	13,14	14,15	21	112
5	19,20	16,16	13,13	15	112
K-5 Total	12 Sections 217 Students (18.1 avg.)	10 Sections 173 Students (17.3avg.)	12 Sections 203 Students (16.9 avg.)	6 Sections 111 Students (18.5 avg.)	40 Sections 704 Students (17.6 avg.)
Note: * The Pre-K program is a half-day program. Pre-K students are not included in the total number of students					

2022-2023 Grade Center Option

2022-2023 Grade Center Option assuming an Equal Distribution of Students				
Grade Level	Total # of Students	Equal Distribution of Students	Current # of Sections	Average Section Size
K	102	51/51	3/3	17.0
1	123	61/62	3/3	20.5
2	129	64/65	3/4	18.4
3	126	63/63	3/4	18.0
4	112	56/56	3/4	16.0
5	112	56/56	3/4	16.0
Total	704	704	40	17.6

Feasibility and Desirability

- Feasible Options: Grade/building arrangements that can be implemented based on available space and facility conditions (Is it possible?)
- Desirable Options: Grade/building arrangements that are feasible and are desirable based on available space, facility conditions, educational soundness and fiscal responsibility (Is it a good idea?)

Break-out Session on Grade Center Configuration (Two Groups)

How would the Grade Center Plan impact transportation?

On average, would students be on buses longer?

Would there be increased costs for additional runs or buses?

Would there be any savings for transportation?



TAKEAWAYS

- The district has few students who walk to school. The average ride for students is approximately 60 minutes.
- The district uses a double trip system. The first trip is for the high school and middle school students and the second trip is for the elementary students. There are 43 trips daily (am & pm).
- The district has approximately 21% of its elementary students attending a school out of their attendance zone.

Next Advisory Committee Meeting
Monday, June 5, 2023
North Broad Elementary School in the gymnasium

(Optional tours will precede each meeting and will begin at 5:45 pm)

Please Note:

- **Meeting Cancelled** - Thursday, May 25, 2023 at North Broad Street Elementary School. (Memorial Day Weekend). Was Rescheduled to June 1
- **Meeting Cancelled** - Thursday, June 1, at North Broad Street Elementary School (conflict with a concert)



(Meetings will begin at 6:30 pm and last no longer than two hours)

Advisory Committee Meeting Schedule

(Meetings will begin at 6:30 pm and last approximately two hours)

- January 26, 2023
- February 16, 2023
- ~~March 13, 2023~~ (March 21)
- April 27, 2023
- ~~May 25, 2023~~ **(June 5)**
- September 28, 2023
- October 26, 2023
- November Date TBD – if necessary



(Optional tours precede meetings 2-7 and will begin at 5:45 pm)

Focus/Location of Each Meeting

Date	Topic	Location
Thursday, January 26	General overview of the study process including the committee's role; student enrollment projections	Costello Training Center
Thursday, February 16	Overview of the elementary program	Durhamville Elem. Gym
Monday, March 13 Tuesday, March 21	Overview of district facilities	Willard Prior Elem. Gym
Thursday, April 27	Overview of district transportation operation; Overview of middle school and high school program	Seneca Street Elem. Gym
Thursday, May 25 Monday, June 5	Staffing patterns in the district; Begin exploring possible future facility options	North Broad Street Elem. Gym
Thursday, September 28	The financial status of the district and continued implications of possible future facility options	Otto Shortell MS Gym
Thursday, October 26	Review of draft final report	Oneida High School Gym
November Date TBD	Review of draft final report	Costello Training Center

Questions ?????

